

PROPOSED

EXISTING

DESCRIPTION

STORMWATER MANHOLE PIPE

SEWER MANHOLE PIPE

EFFLUENT MANHOLE PIPE

RAIL LINE

COMMUNICATION MANHOLES/DUCTS

ELECTRICAL MANHOLES/DUCTS

WATERMAIN

FENCE

CATCHMENTS BOUNDARY

EXISTING OIL LINE

NEW STORMWATER IN ADJACENT PROJECT AREAS

RELOCATED SERVICE

DEMOLISH EXISTING SERVICE

ASPHALT ROAD

EARTH BANKS

NEW BLOCK PAVEMENT

PROPOSED MOUNTABLE KERB

SETTING OUT COORDINATE

- R - RAIL ENHANCEMENT
- M - MULTI PURPOSE TERMINAL
- S - STOCKPILE
- C - CAUSEWAY
- T - TIPPLER

BENCHMARK

ABBREVIATIONS

EX = EXISTING

FH = FIRE HYDRANT

MH = MANHOLE

BM = BENCH MARKS

V = WATERMAIN VALVE

E.L.P. = ELECTRICAL LIGHT POLE

SW = STORMWATER

EF = EFFLUENT

H.M.L. = HIGH MAST LIGHT

MANHOLE COORDINATES

MH ID	X	Y
SM1	-94345.504	3655354.474
SM2	-94330.453	3655313.887
SM3	-94293.088	3655212.715
SM4	-94260.077	3655122.969
SM5	-94226.877	3655032.989
SM6	-94176.944	3654987.547
SM7	-94147.928	3654819.014
SM8	-94118.920	3654740.583
SM9	-94040.109	3654526.546
SM10	-94015.277	3654448.357
SM11	-93944.614	3654287.186
SM12	-93883.177	3654105.898
SM13	-93812.880	3654078.017
SM14	-93799.405	3654063.084
SM15	-93844.777	3654008.219
SM16	-93841.224	3653994.695
SM17	-93819.813	3654003.454
SM18	-93805.868	3654009.428
SM19	-93801.672	3654031.851
SM20	-93797.308	3654041.397
SM21	-93697.743	3654011.845
SM22	-93683.303	3654007.938
SM23	-93655.135	3654006.645
SM24	-93649.643	3654006.214
SM25	-93626.242	3654015.571
SM26	-93559.651	3654038.807
SM27	-93528.199	3654031.441
CM1	-93763.568	3654048.599
CM2	-93750.952	3654045.083
CM3	-93708.647	3654018.437
CM4	-93454.278	3654043.082
CM5	-93426.127	3654053.908
CM6	-93403.373	3654047.786
CM7	-93385.797	3654054.512

- GENERAL NOTES:
- THE CONTRACTOR WILL BE DEEMED TO HAVE INSPECTED THE SITE AND BE IN AGREEMENT WITH THE WORKS REQUIRED AS PER THE TENDER DOCUMENTS, UNLESS ALTERNATIVE PROPOSALS WITH COST IMPLICATIONS ARE RECEIVED TOGETHER WITH THE TENDER DOCUMENTS. ALTERNATIVE PROPOSALS SUBMITTED DURING CONSTRUCTION SHALL BE ON A DESIGN AND CONSTRUCT BASIS, WITH THE DESIGN AT CONTRACTOR'S EXPENSE.
 - VARIATIONS DEEMED NECESSARY BY THE CONTRACTOR SHALL BE FORWARDED TO THE PROJECT MANAGER IN WRITING FOR APPROVAL BEFORE ANY CONSTRUCTION BASED ON THE VARIATION COMMENCES.
 - SERVICES SHOWN ON DRAWINGS ARE KNOWN OR SOURCED FROM EXISTING DRAWINGS. THE CONTRACTOR MUST ENSURE THAT ALL SERVICES THAT INTERSECT OR RUN ALONGSIDE THE PROPOSED WORKS ARE LOCATED BEFORE CONSTRUCTION COMMENCES. ANY CLASHES SHALL BE REPORTED TO THE PROJECT MANAGER IN WRITING. THE CONTRACTOR SHALL BE HELD LIABLE FOR ANY DAMAGES TO EXISTING SERVICES DUE TO NEGLIGENCE.
 - ALL EXISTING PIPES AND MANHOLES INCORPORATED INTO THE NEW SYSTEM SHALL HAVE DEFECTS RECTIFIED TO COMPLY TO STANDARDS FOR NEW WORKS.
 - DIMENSIONS SHOWN ON DRAWINGS SHALL TAKE PREFERENCE OVER DIMENSIONS SCALED.
 - ALL LEVELS AND DIMENSIONS SHALL BE CHECKED BEFORE ANY WORK COMMENCES. FAILURE TO DO SO SHALL DEEM THE CONTRACTOR LIABLE FOR ANY WORK REQUIRED TO RECTIFY ERRORS AS A RESULT OF THE FAILURE TO CHECK THE LEVELS AND DIMENSIONS.
 - ALL DIMENSIONS ARE IN MILLIMETERS AND LEVELS ARE IN METERS, UNLESS OTHERWISE INDICATED.
 - THE LATEST REVISION OF SANS SPECIFICATIONS SHALL APPLY. ALL WORK SHALL BE DONE IN ACCORDANCE WITH RELEVANT SANS SPECIFICATIONS, UNLESS OTHERWISE INDICATED.
 - ALL LENGTHS SHOWN ARE APPROXIMATE AND SHALL BE CONFIRMED ON SITE BY CONTRACTOR.
 - THE CONTRACTOR MUST ENSURE THAT THE METHOD FOR CONSTRUCTION INSIDE THE EXISTING OIL LINE SERVICE AND CROSSING THE OIL LINE WITH ANY NEW SERVICE SHOULD BE CONFIRMED AND FOLLOWED EXACTLY. THE EXISTING OIL LINE SHOULD NOT BE DAMAGED OR DISTURBED IN ANY WAY DURING CONSTRUCTION.

- EARTHWORKS
- ANY DISCREPANCIES IN LEVELS AND SETTING OUT DATA TO BE QUERIED WITH THE ENGINEER PRIOR TO COMMENCEMENT OF ANY WORK.
 - ALL WORKMANSHIP TO BE IN ACCORDANCE WITH SANS 100 PART 7: EARTHWORKS AND THE RELEVANT PROJECT SPECIFICATIONS AS INCLUDED IN THE CONTRACT.
 - BEFORE PLACING ANY FILL MATERIAL, THE EXISTING GROUND SURFACE MUST BE CLEARED AND GRUBBED OF ALL VEGETATION AND ORGANIC MATTER.
 - UNLESS OTHERWISE INDICATED, ALL BANK BATTERS TO BE: 1:1.5 CUT AND 1:2 FILL.
 - THE UNCOMPLICATED THICKNESS OF FILL LAYERS SHALL NOT EXCEED 300mm.
 - LOCATE ALL EXISTING SERVICES IN AREA PRIOR TO ANY CONSTRUCTION TAKING PLACE.

- STORMWATER NOTES
- TRENCHES FOR PIPES TO BE ECKWATKED AND BACKFILLED IN ACCORDANCE WITH THE REQUIREMENT OF SANS 1030 DB - PIPE TRENCHES
 - ALL RIGID CONCRETE PIPES SHALL HAVE CLASS B BEDDING
 - FOR STORMWATER PIPES SHALL BE SPOOT & SOCKET CLASS 1000 (SANS 677)
 - ALL CONCRETE PIPE JOINTS TO BE WRAPPED WITH 12 BIDIM (NONWOVEN CONTINUOUS FILAMENT NEEDLE PUNCHED POLYESTER GEOTEXTILE) MIN. WIDTH TO BE 750mm FOR PIPES 3000 TO 6000
 - NO ALL MANHOLE COVERS TO SUIT CROSSFALL OF FINISHED PAVING
 - ON COMPLETION, THE INSTALLATION SHALL BE TESTED TO THE ENGINEER'S SPECIFICATION
 - THE CONTRACTOR SHALL SUBMIT A FULL SET OF AS-BUILT DRAWINGS UPON COMPLETION OF THE INSTALLATION
 - ALL EXISTING STORMWATER PIPES, MANHOLES AND CHANNELS TO BE CLEARED AND CLEARED OF ALL DEBRIS BEFORE ANY WORK COMMENCES
 - ANY DISCREPANCIES IN LEVELS AND SETTING OUT DATA TO BE QUERIED WITH THE ENGINEER PRIOR TO COMMENCEMENT OF ANY WORK
 - ALL EXISTING STORMWATER PIPES ARE CONCRETE
 - WHERE MINIMUM COVER OF 1000mm FOR OPERATIONAL AREAS & 600mm FOR NON OPERATIONAL AREA CANNOT BE ACHIEVED, CONCRETE ENCASEMENT IS REQUIRED AS PER THE DETAIL DRAWINGS.
 - PLEASE SEE S200157-2-001-C-DE-0001-01 FOR ALL POND SETTING OUT COORDINATES AND POND DETAILS.

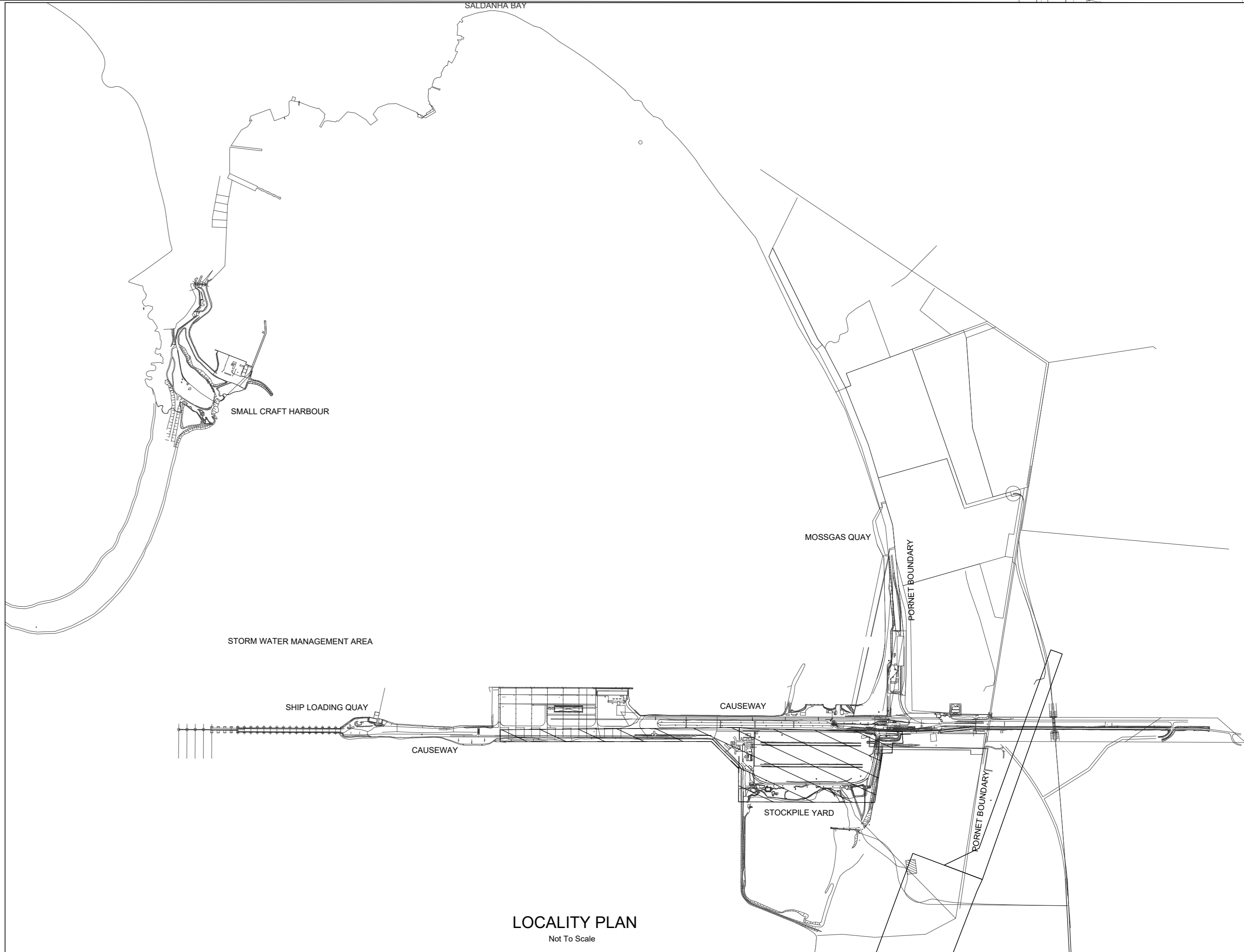

DRAWING NO.	DESCRIPTION
S200157-2-001-C-LA-0001-01	STOCKYARD AREA GENERAL LAYOUT
S200157-2-001-C-LA-0001-02	STOCKYARD AREA STORMWATER LAYOUT
S200157-2-001-C-LA-0001-03	DEMOLITION LAYOUT
S200157-2-001-C-SE-0001-01	STOCKYARD AREA STORMWATER LONG SECTIONS SHEET 1 OF 3
S200157-2-001-C-SE-0001-02	STOCKYARD AREA STORMWATER LONG SECTIONS SHEET 2 OF 3
S200157-2-001-C-SE-0001-03	STOCKYARD AREA STORMWATER LONG SECTIONS SHEET 3 OF 3
S200157-2-001-C-DE-0001-01	STOCKYARD AREA POND DETAILS
S200157-2-001-C-DE-0001-02	TYPICAL STORMWATER MANHOLE DETAILS
S200157-2-001-C-DE-0001-03	TYPICAL STORMWATER GRID INLET & CATCHPIT DETAILS
S200157-2-001-C-DE-0001-04	TYPICAL HEADWALL, SCOUR & CONCRETE ENCASEMENT DETAILS

- NOTES:
- MEASUREMENTS ARE BASED ON METRIC SYSTEM.
 - ALL LEVELS ARE IN METERS TO MEAN SEA LEVELS (MSL)
 - DO NOT SCALE DRAWING - ONLY DIMENSIONS SHOWN TO BE USED.
 - THE CONTRACTOR SHALL VERIFY ALL SERVICES OR CONDITIONS ON THE SITE AND NOTIFY THE ENGINEERING OF ANY VARIATIONS FROM DIMENSIONS BEFORE CONSTRUCTION.

CONTRACTOR / CONSULTANT

TITLE	NAME	SIGN	DATE
-	-	-	-
-	-	-	-
-	-	-	-
-	-	-	-
-	-	-	-

TRANSNET PORT TERMINALS

TITLE	NAME	SIGN	DATE
-	-	-	-
-	-	-	-
-	-	-	-
-	-	-	-
-	-	-	-

OPERATING DIVISIONS

TITLE	NAME	SIGN	DATE
-	-	-	-
-	-	-	-
-	-	-	-
-	-	-	-
-	-	-	-

REVISIONS

NO.	DESCRIPTION	BY	CHKD	APPD	DATE
00	ISSUED FOR CONSTRUCTION	HD	RM	RN	04/08/2023
01	ISSUED FOR CLIENT APPROVAL	HD	RM	RN	01/07/2022

PR. ENG. / PR. TECH. / PR. ARCH

NAME	SIGN	DATE
-	-	-
-	-	-
-	-	-
-	-	-
-	-	-

PROJECT NUMBER

PROJECT NUMBER	OD	FBS	DIS	TYPE	DRAWING NO.	SHEET	REV	ID
A052001572001CLA00010300	HD							



PORT OF SALDANHA

SALDANHA STORMWATER MANAGEMENT
STOCKYARD AREA
DEMOLITION LAYOUT